



# STRIKE MODULAR CHASSIS FOR FN HERSTAL PS90

## USER MANUAL

### WARNING – FIREARM SAFETY NOTICE

This product is a firearm chassis conversion kit intended for use with compatible firearms only. Improper installation, modification, or use may result in serious injury, death, or property damage.

- **ALWAYS ensure the firearm is completely UNLOADED** before installation, removal, inspection, or adjustment. Remove the magazine, clear the chamber, and visually and physically verify that the firearm is unloaded.
- Installation of this chassis may alter the firearm's handling, controls, balance, and operation.
- **Professional installation by a qualified gunsmith is strongly recommended.**
- Do not attempt installation if you are unfamiliar with firearm mechanics or safe firearm handling practices.
- After installation, perform a full function and safety check before loading or firing.
- Use only quality, factory-manufactured ammunition of the correct caliber.
- Follow all local, state, and federal laws regarding firearm modification, ownership, and use.

Failure to follow these warnings and instructions may result in serious injury or death.



STRIKE INDUSTRIES®



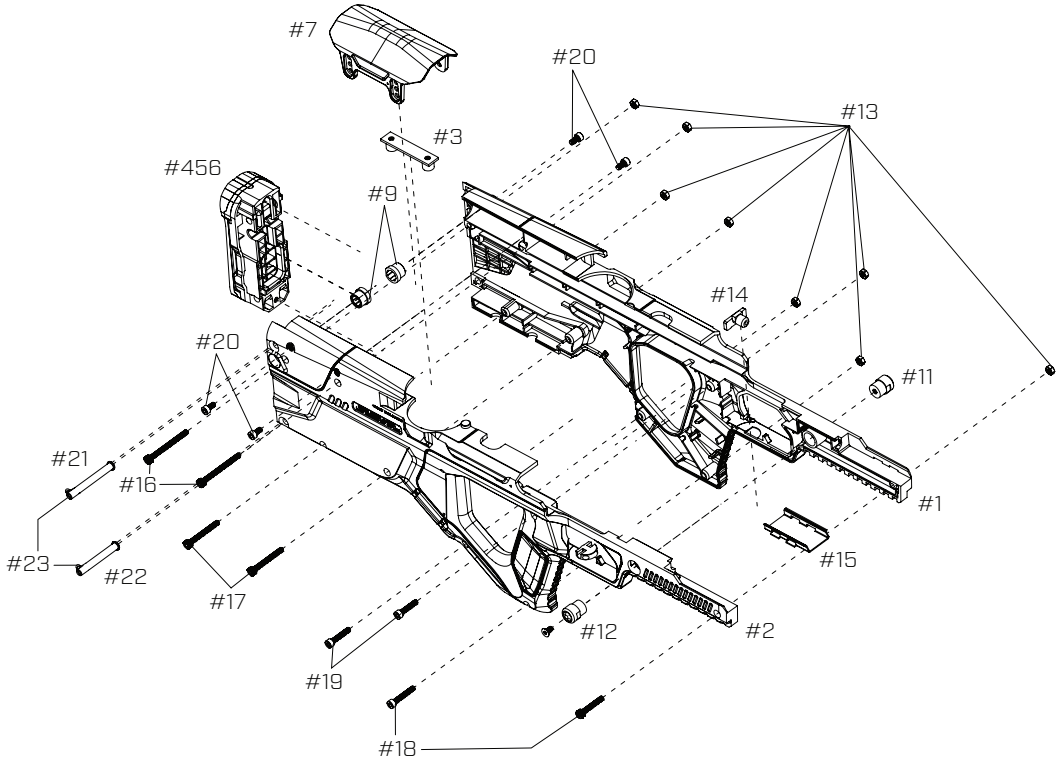

**⚠ DISCLAIMER ⚠**

FN® PS90™ is a federally registered trademark of FN Browning Group. Neither Strike Industries nor this product are affiliated in any manner with, or otherwise endorsed by, FN Browning Group. The use "PS90" on this packaging is merely to advertise the sale of third party accessories for FN Browning Group pistols, rifles, parts, or components. For additional genuine FN Browning Group parts, visit [fnamerica.com](http://fnamerica.com).

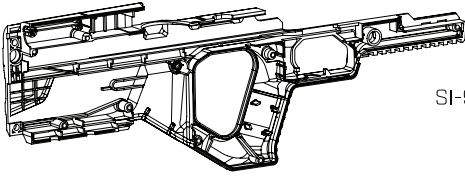

SI-90 Chassis Left - x1

**PART #1**

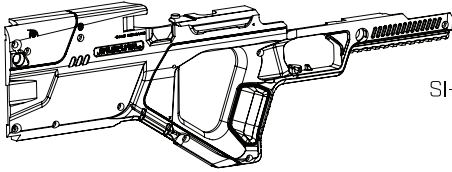

SI-90 Chassis Right - x1

**PART #2**

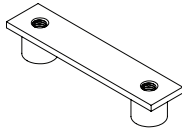

Accessory mounting point rear - x1

**PART #3**

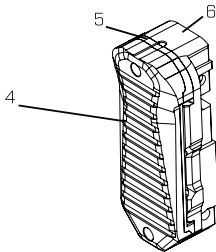

Buttstock assembly - x1

**PART #456**

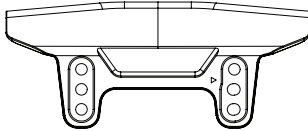

Cheekrest - x1

**PART #7**

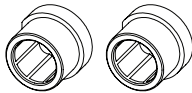

Rear QD insert - x2

**PART #9**



Taper Head M4 x 8mm - x1

**PART #10**

**A**



Front QD insert L - x1 (flat inside)

**PART #11**



Front QD insert R - x1 (tapered inside)

**PART #12**



M4 Nut - x8

**PART #13**

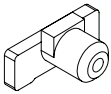

Centering Nub for Upper Receiver - x1

**PART #14**

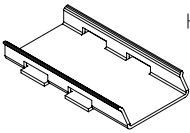

Heat Shield - x1

**PART #15**

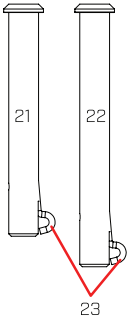

21 Bottom buttstock pin - x1

22 Top buttstock pin - x1

23 Pin springs - x2

**PART #21**  
**PART #22**  
**PART #23**

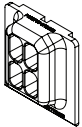

Trigger pack spacer - x1

**PART #24**

**B**

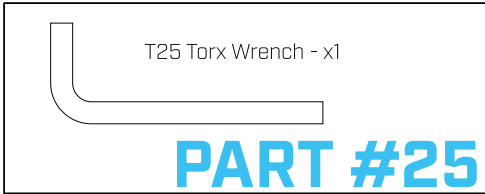
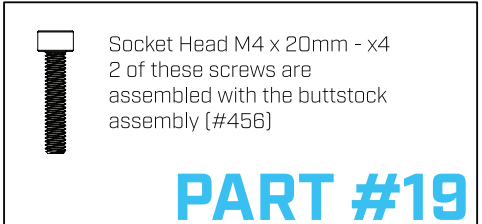
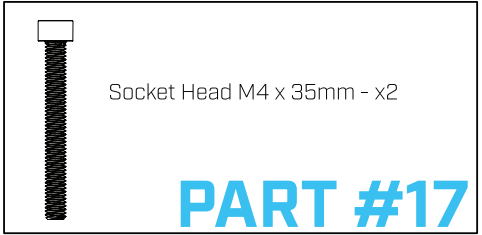
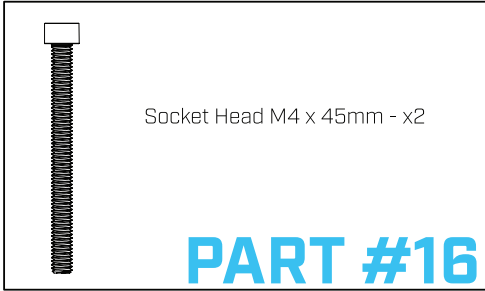

# C

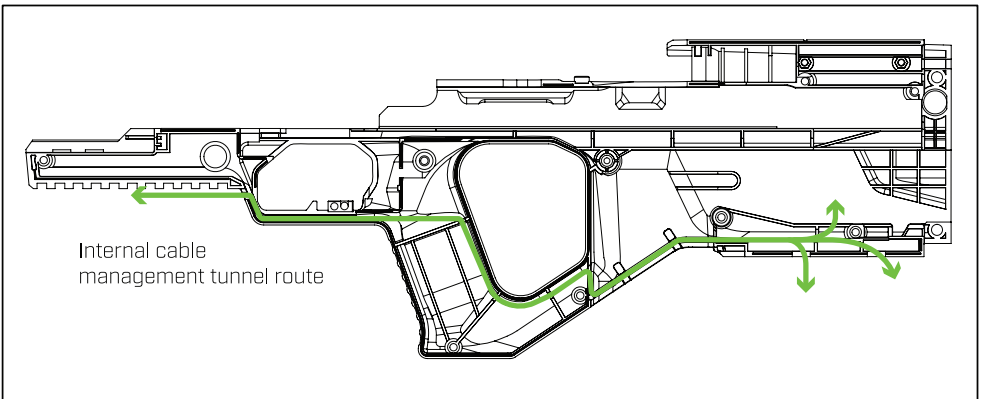

**Step 1**  
Remove stock pins

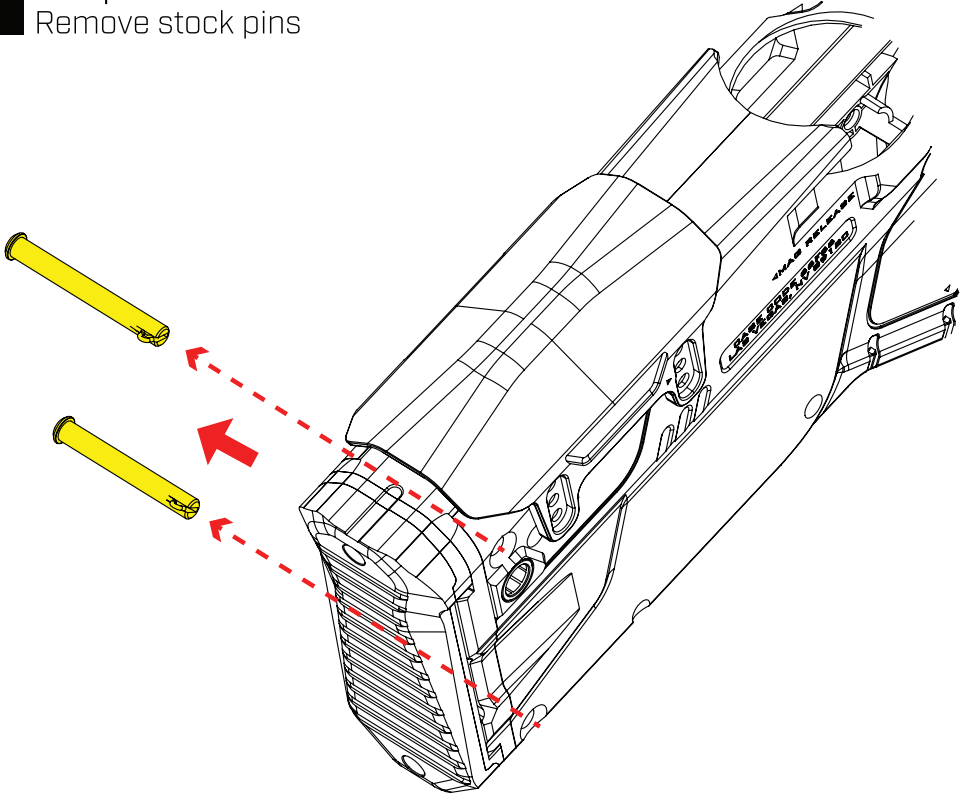

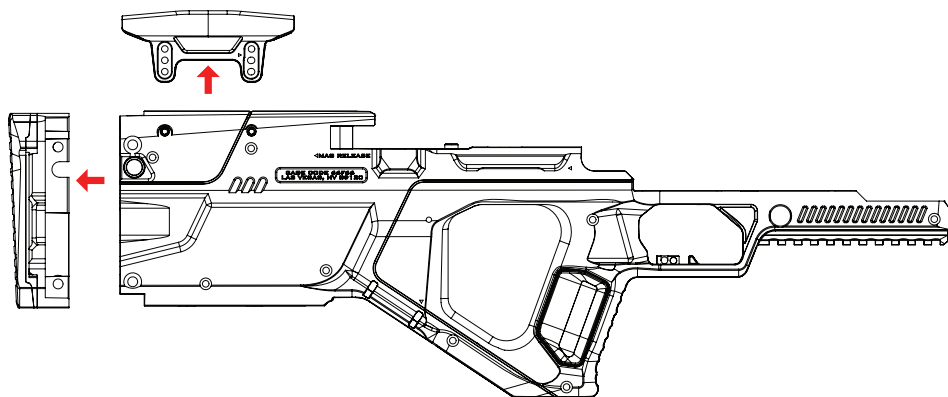

2

Step 2  
Remove stock, and remove cheek rest

### Step 3

Rear QD inserts are loose, so please pay attention while taking the buttstock off.

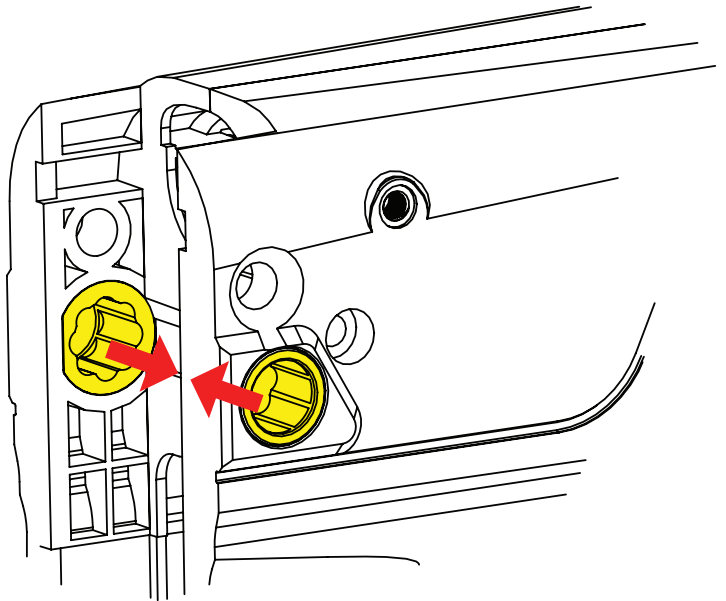

## Step 4

Split the two bodies and lay all the original internal parts (Trigger, trigger pack, selector switch, mag release, and dust cover) from your P/PS90 into the right side of SI-90 chassis along with additional parts from the SI-90 kit to complete the build.

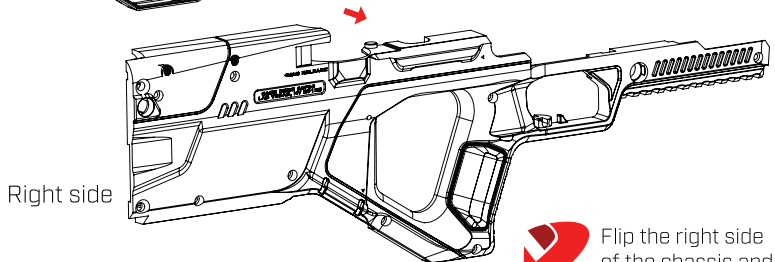
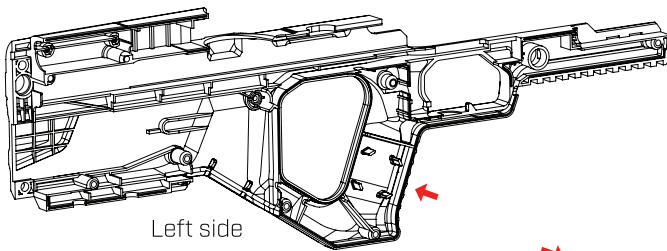

Flip the right side of the chassis and lay it flat on your work space

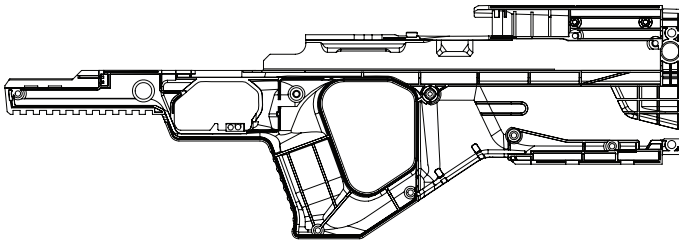

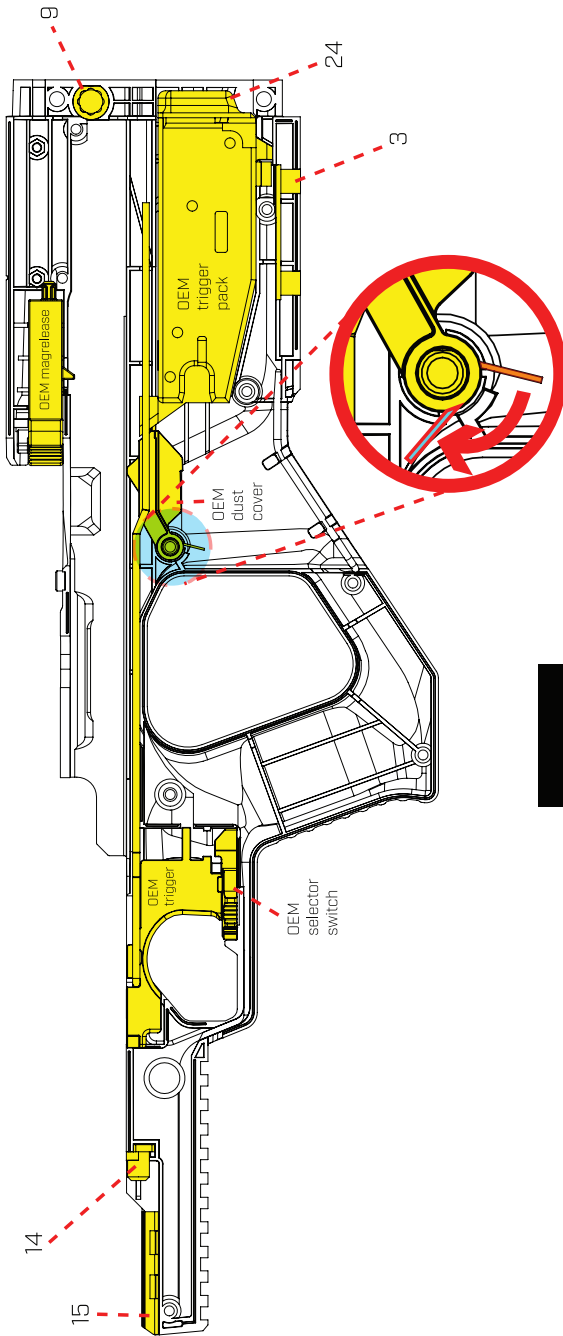

Must make sure that the spring is loaded before closing the housing with screws

## Step 5

Internal components layout  
Please refer to page 1-3 for the parts list

## Step 6

After step 5 is complete, put the left side of the chassis together with the preassembled chassis. Please pay attention to the dust cover spring position, make sure it is in the correct position. Once the two bodies are properly aligned, insert the rear QD nut into the chassis from the inside. If you have issues with the P/PS90 assembly/disassembly please refer to a gunsmith.

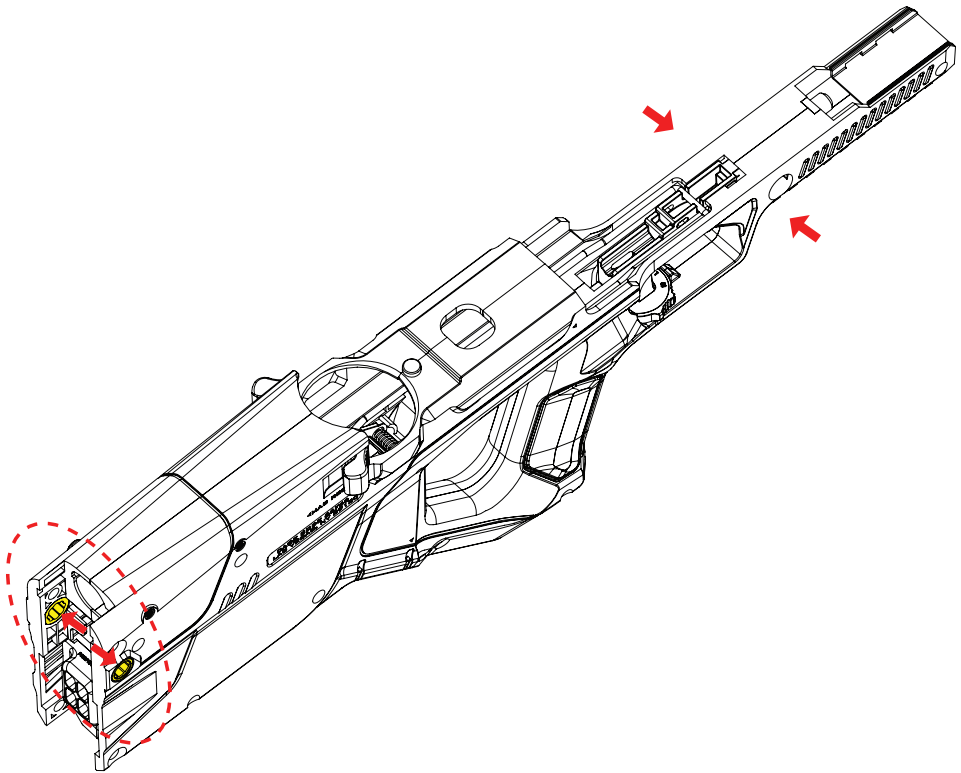

## Step 7

Insert the buttstock assembly [#456] into place and secure it with the pins [#21 & #22].

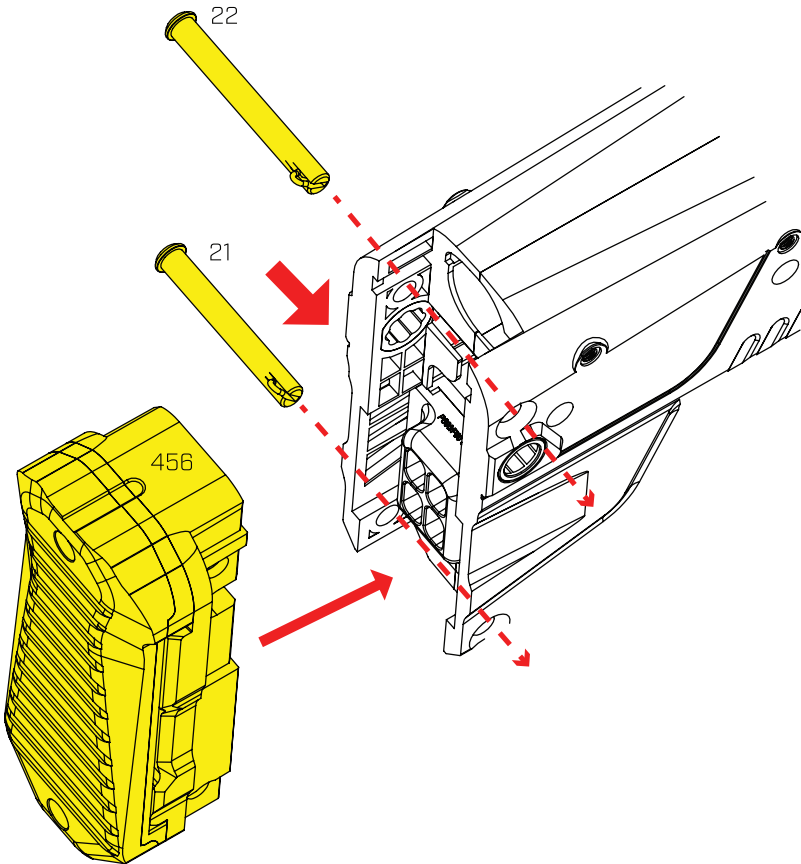

## Step 8

Insert the front QD nuts [11 and 12] and screw them together with the provided screw [10].

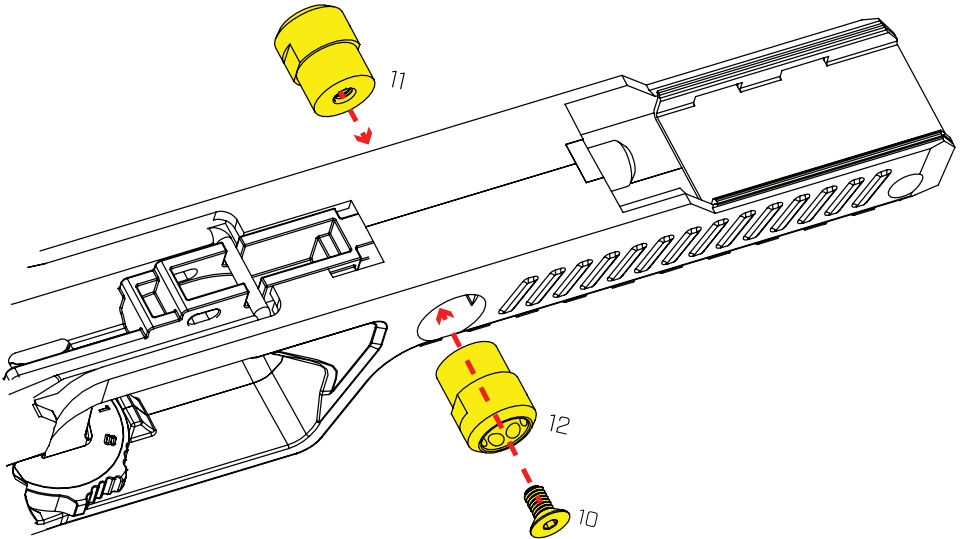

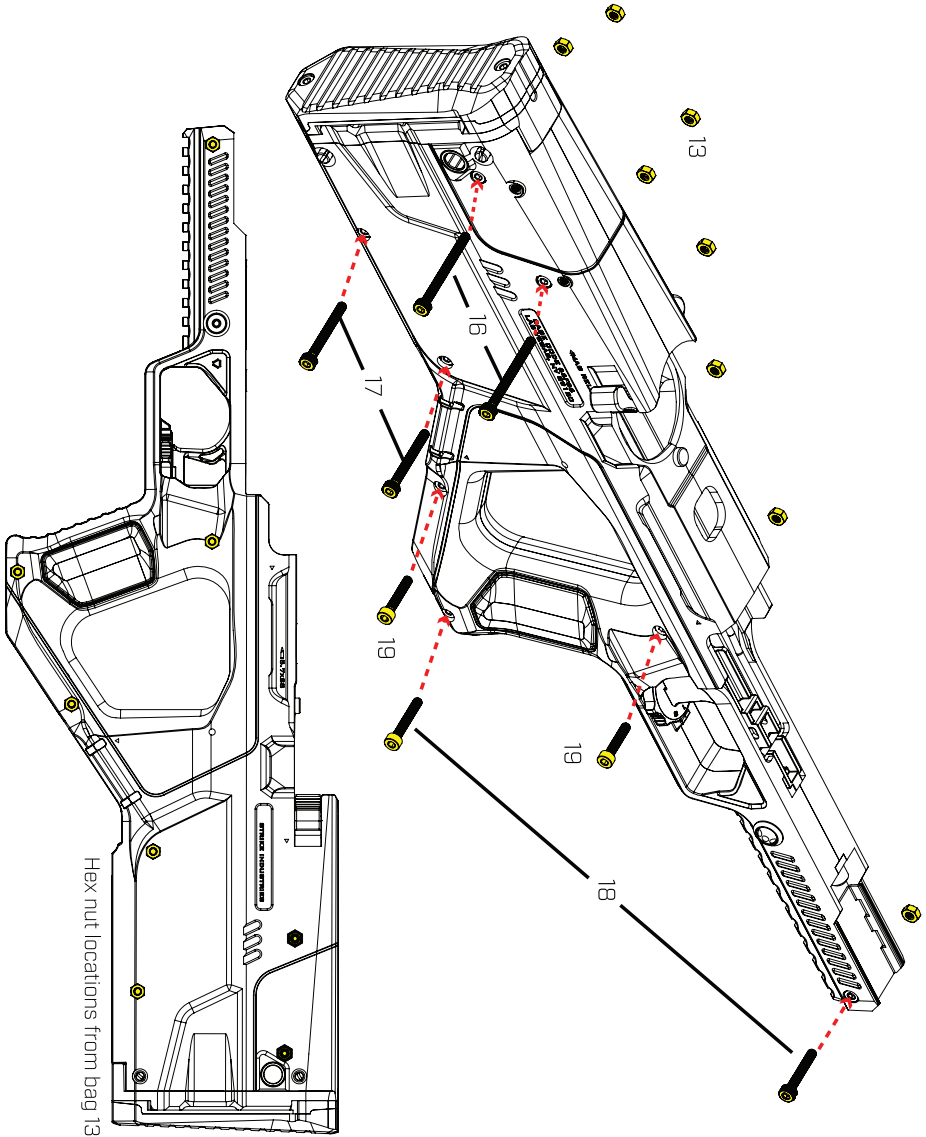

## Step 9

Insert all the screws into the screw holes and put the corresponding hex nuts on the otherside.

## Step 10

Install the cheekrest using the provided screws (20)

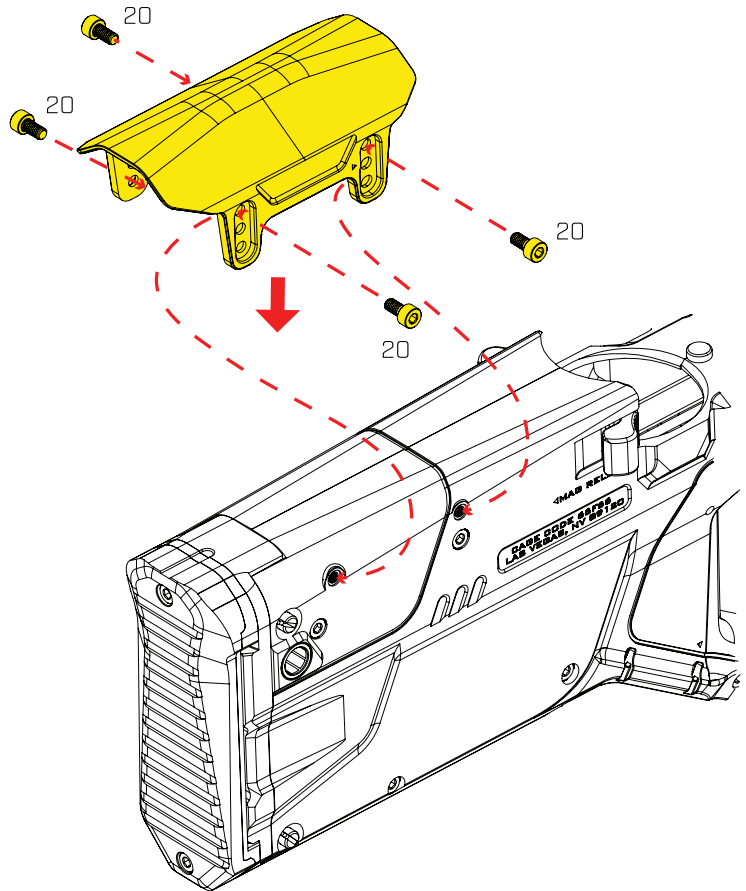

## Step 11

Once all the screws and nuts are tightened together, the SI-90 Chassis is ready to be assembled with the rest of the P/PS90 parts. Then insert bolt, and insert the P/PS90 upper receiver. Make sure the lock bar on the upper receiver is fully engaged after the installation.

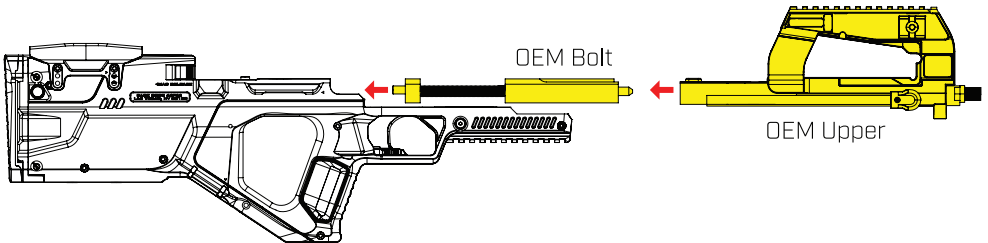

## Step 12

Optional part: Complete your chassis with Strike Industries SI-90 Aluminum Handguard in either short or long length along with other accessories of your desire.

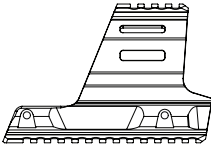
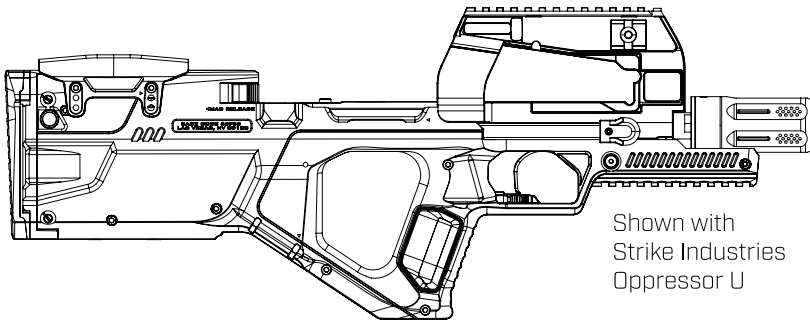

Optional part: Short Handguard

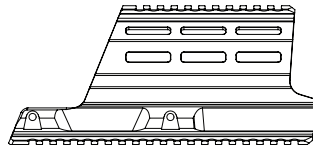

Optional part: Long Handguard

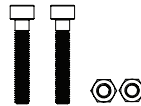

Included with 2x M5x35mm  
socket head screws and nuts





**STRIKE INDUSTRIES®**